

ROHS COMPLIANT

1.27mm Pin Header Dual Row SMT Type

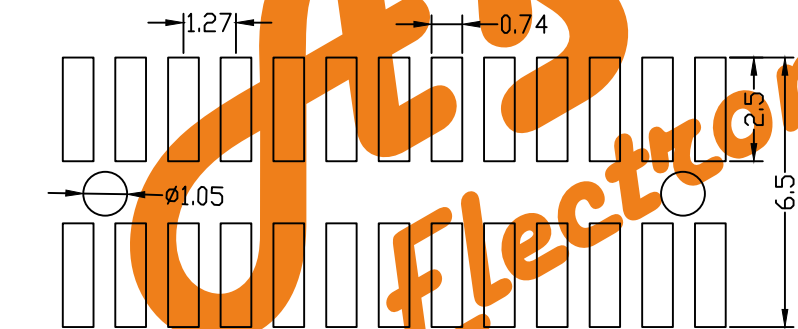

PCB LAYOUT

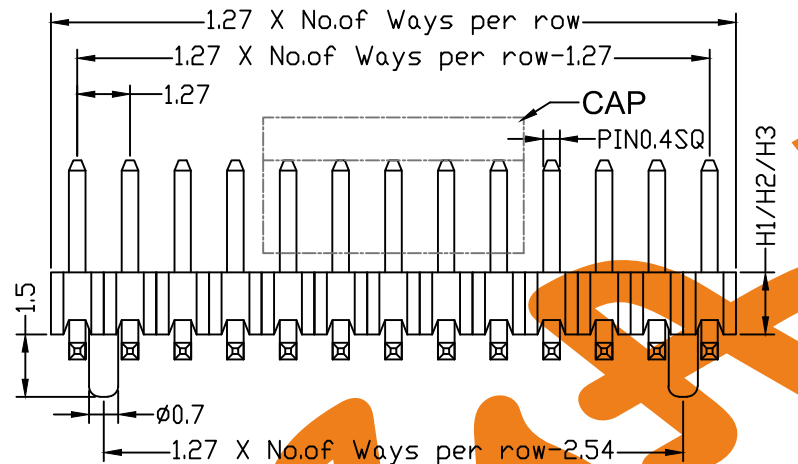
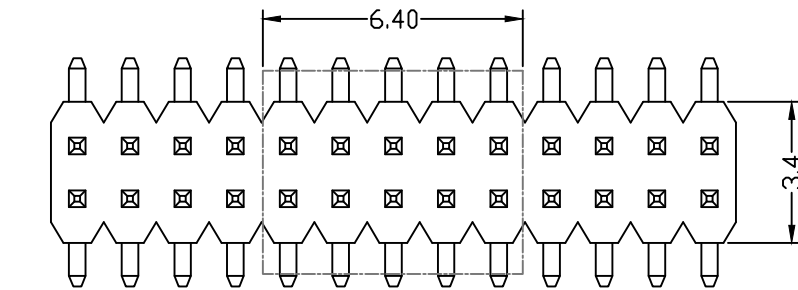
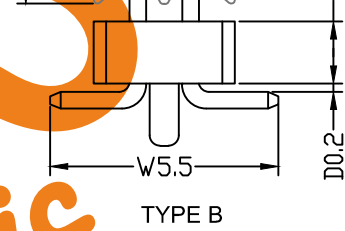
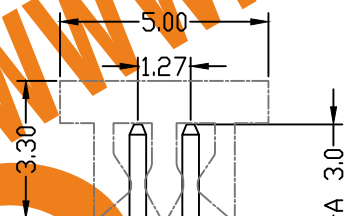
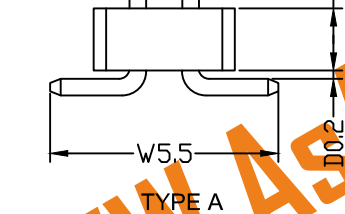
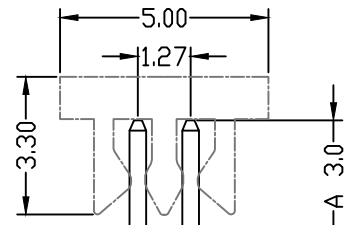

TYPE B

SPECIFICATION

Current Rating: 1Amp  
 Insulation Resistance: 5000M ohms min  
 Contact Resistance: 20M ohms max  
 Dielectric Withstanding: AC500V  
 Operating Temperature: -65°C to +125°C  
 Contact Material: Brass  
 Insulator Material: PBT, UL 94V-0 Black

Ordering Code:

PHCM11 - X - X - D - X - X - X - X - X  
 ① ② ③ ④ ⑤ ⑥ ⑦ ⑧ ⑨

- ① Series No:
- ② No. of Contacts: 02 To 100
- ③ Contact Plating: G0: Gold flash, G1: 3u" Gold, G2: 5u" Gold, G3: 10u" Gold, G4: 15u" Gold, G5: 30u" Gold, SN: Tin
- ④ Connector Type: D: Dual
- ⑤ Pin Length: A+(W-1.27)/2+D+1.07+H1/H2/H3. Please mark the desired length in the A/B
- ⑥ Insulator Material: B: PA6T, C: LCP, D: PA46
- ⑦ Packing: A: Tray, B: Bag, T: Tube, U: Tube+CAP, R: Tape&Reel, W: Tape&Reel+CAP
- ⑧ Plastic High: H1: 0.85mm, H2: 1.0mm, H3: 1.5mm
- ⑨ Special Function: A: Type A, B: Type B

Unless Otherwise specified tolerance

A	W	D
3.0	5.5	0.2

X: ±0.35  
 X.X: ±0.25  
 X.XX: ±0.20  
 X.XXX: ±0.15

SCALE: As Shown  
 UNIT: mm

Optional



AsA Electronic Co.

Tel : (+98) 21 66 73 56 82 Mob : (+98) 912 03 161 02

DRAWN: junfon H

CHECKED: YANG

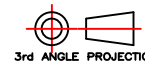

TITLE: 1.27mm Pin Header Dual Row SMT Type

DRAWING NO: PHCM11-XXDXXXXX

PRODUCT NO: PHCM11-XXDXXXXX

Add option of plating

10/8/1

DESCRIPTION

DATE

REV